

## **Appendix 1, Environmental Data Reports**



## EDR NEPAScreen™ DESCRIPTION

The National Environmental Policy Act of 1969 (NEPA) requires that Federal agencies include in their decision-making processes appropriate and careful consideration of all environmental effects and actions, analyze potential environmental effects of proposed actions and their alternatives for public understanding and scrutiny, avoid or minimize adverse effects of proposed actions, and restore and enhance environmental quality as much as possible.

The EDR NEPAScreen provides information which may be used, in conjunction with additional research, to determine whether a proposed site or action will have significant environmental effect.

The report provides maps and data for the following items (where available). Search results are provided in the Map Findings Summary on page 2 of this report.

### Section

#### Natural Areas Map

- Federal Lands Data:
  - Officially designated wilderness areas
  - Officially designated wildlife preserves, sanctuaries and refuges
  - Wild and scenic rivers
  - Fish and Wildlife
- Threatened or Endangered Species, Fish and Wildlife, Critical Habitat Data (where available)

#### Historic Sites Map

- National Register of Historic Places
- State Historic Places (where available)
- Indian Reservations

#### Flood Plain Map

- National Flood Plain Data (where available)

#### Wetlands Map

- National Wetlands Inventory Data (where available)

#### FCC & FAA Map

- FCC antenna/lower sites, FAA Markings and Obstructions, Airports, Topographic gradient

#### Key Contacts and Government Records Searched

## MAP FINDINGS SUMMARY

The databases searched in this report are listed below. Database descriptions and other agency contact information is contained in the Key Contacts and Government Records Searched section on page 20 of this report

### TARGET PROPERTY ADDRESS

2763 RILEY ROAD  
EAGLE POINT, OR 97524

### TARGET PROPERTY COORDINATES

Latitude (North): 42.466476 - 42.27 59.3"  
Longitude (West): 122.782143 - 122.48 55.7"  
Zone 10  
UTM X (Meters): 517910.5  
UTM Y (Meters): 4701379.5

### Applicable Regulation from 47 CFR/FCC Checklist

#### NATURAL AREAS MAP

- 1.1307a (1) Officially Designated Wilderness Area
- 1.1307a (2) Officially Designated Wildlife Preserve
- 1.1307a (2) Officially Designated Wildlife Preserve
- 1.1307a (3) Threatened or Endangered Species or Critical Habitat

#### HISTORIC SITES MAP

- 1.1307a (4) Listed or eligible for National Register
- 1.1307a (4) Listed or eligible for National Register
- Indian Reservation

#### FLOODPLAIN MAP

- 1.1307 (6) Located in a Flood Plain

#### WETLANDS MAP

- 1.1307 (7) Change in surface features (wetland fill)

#### FCC & FAA SITES MAP

Database	Search Distance (Miles)	Within Search	Within 1/8 Mile
US Federal Lands	0.25	NO	NO
US Federal Lands	0.25	NO	NO
OR BLM Owned Lands	0.25	NO	NO
County Endangered Species	County	YES	N/A
National Register of Hist. Pla	0.25	NO	NO
OR Historic Sites	0.25	NO	NO
Indian Reservation	0.25	NO	NO
FLOODPLAIN	0.25	NO	NO
NWI	0.25	NO	NO
Cellular	0.25	NO	NO
4G Cellular	0.25	NO	NO
Antenna Structure Registration	0.25	NO	NO
Towers	0.25	NO	NO
AM Antenna	0.25	NO	NO
FM Antenna	0.25	NO	NO
FAA DOF	0.25	NO	NO
Airports	0.25	NO	NO
Power Lines	0.25	NO	NO

# Natural Areas Map

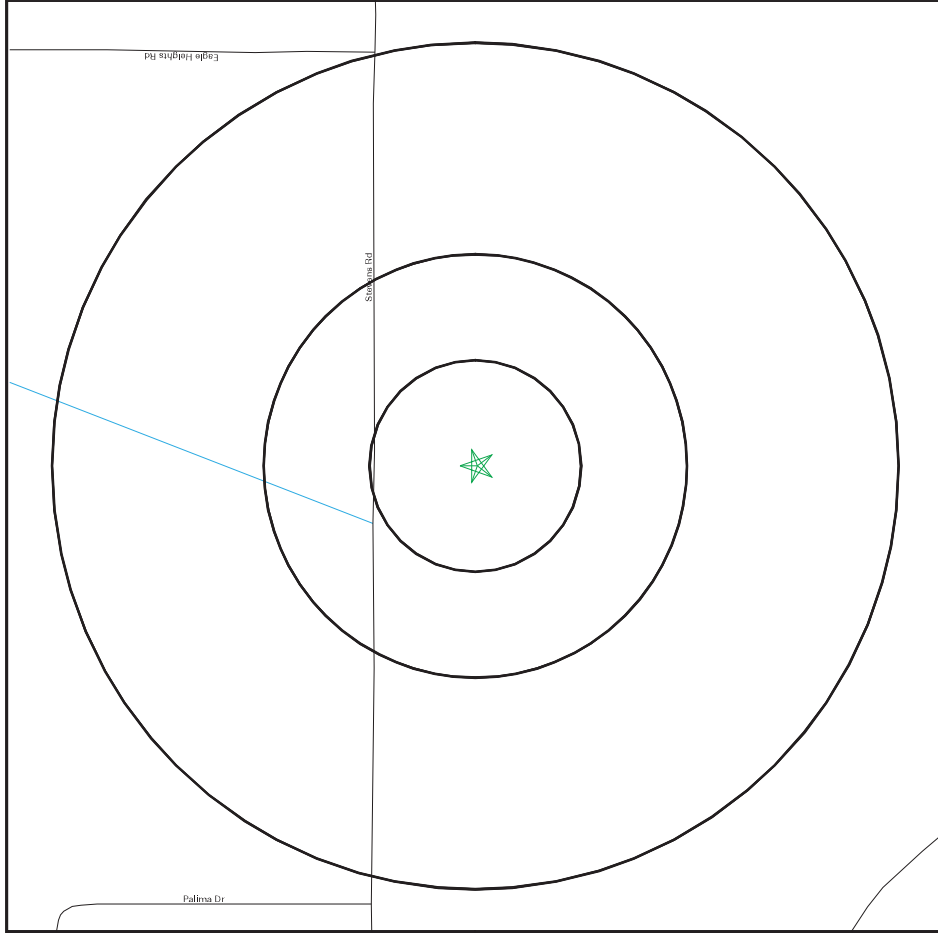

★ Target Property  
⬢ Roads  
⬢ County Boundary  
⬢ Waterways  
⬢ Water  
⬢ Locations  
⬢ Federal Areas  
⬢ Federal Linear Features  
⬢ State Areas  
⬢ State Linear Features

0 1/16 1/8 1/4 1/2 Miles

North Arrow

**SITE NAME:** 2763 RILEY ROAD  
**ADDRESS:** Eagle Point, OR 97524  
**LAT/LONG:** 42.46657 - 122.7821

**CLIENT:** Department of Veterans Affairs  
**CONTACT:** na  
**INQUIRY #:** Online\_Report  
**DATE:** TCOnline\_Report Pg

Copyright © 2010 EDR, Inc. © 2010 Top Atlas Inc. 07/2008.

# NATURAL AREAS MAP FINDINGS

**Endangered Species Listed for: JACKSON County, OR**  
 Source: EPA Endangered Species Protection Program Database  
 BIRD: OWL, NORTHERN SPOTTED  
 BIRD: EAGLE, BALD  
 FISH: SALMON, COHO (SOUTHERN OR/NORTHERN CA COAST)  
 FISH: STEELHEAD, KLAMATH MOUNTAINS PROVINCE  
 FISH: STEELHEAD, KLAMATH MOUNTAINS PROVINCE  
 FISH: SALMON, COHO (OREGON COAST POPULATION)  
 PLANT: LOMATIUM, COOK'S  
 PLANT: MEADOWFOAM, LARGE-FLOWERED WOOLY  
 PLANT: FRITILLARY, GENTNER'S

Map ID	Direction	Distance	EDR ID
			Database
No mapped sites were found in EDR's search of available government records within the search radius around the target property.			

# Historic Sites Map

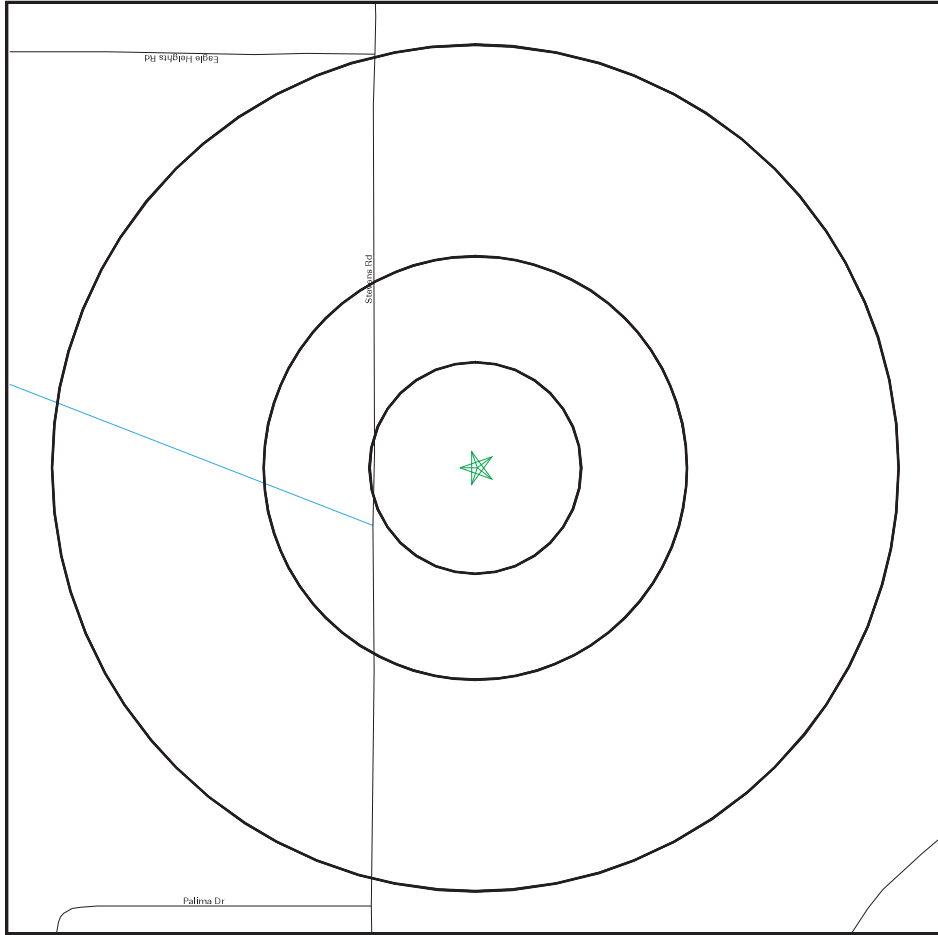

★ Target Property  
▭ Streets  
▭ County Boundary  
▭ Waterways  
▭ Water  
◆ Historic Sites  
▭ Federal Historic Areas  
▭ State Historic Areas  
▭ US Indian Reservations  
▭ Scenic Trail

0 1/16 1/8 1/4 1/2 Miles

**SITE NAME:** 2763 RILEY ROAD  
**ADDRESS:** Eagle Point, OR 97524  
**LAT/LONG:** 42.46657 - 122.7821

**CLIENT:** Department of Veterans Affairs  
**CONTACT:** na  
**INQUIRY #:** Online\_Report  
**DATE:** TCOnline\_Report Pg

# HISTORIC SITES MAP FINDINGS

Map ID  
 Direction  
 Distance  
 Distance (ft.)

EDR ID  
 Database

No mapped sites were found in EDR's search of available government records within the search radius around the target property.

## UNMAPPABLE HISTORIC SITES

Due to poor or inadequate address information, the following sites were not mapped:

Status  
EDR ID  
Database

Unmappable  
88000273  
National Register of Hist. Places

Refnum: 88000273  
Resname: Antelope Creek Covered Bridge  
Address: Little Butte Creek, 35 ft. E of Main St. crossing  
Resource Type: Structure  
Number buildings: 000000  
Number sites: 000000  
Number structs: 000001  
Number objects: 000000  
Non-contrib bldg: 000000  
Non-contrib sites: 000000  
Non-contrib structs: 000000

Primary Certification: 000000  
Date received/pending nomination: 19880404  
Acreage: 9  
Oregon Covered Bridges TR  
Alternate name: Jackson  
County: Eagle Point  
City: Architecture/Engineering  
Areas of significance: Transportation  
Current Function: Concrete  
Building Material: Weatherboard  
Building Material: Shingle  
Building Material: Wood

Alternate name: Little Butte Creek Pedestrian Bridge-Jackson County Bridge N

## Flood Plain Map

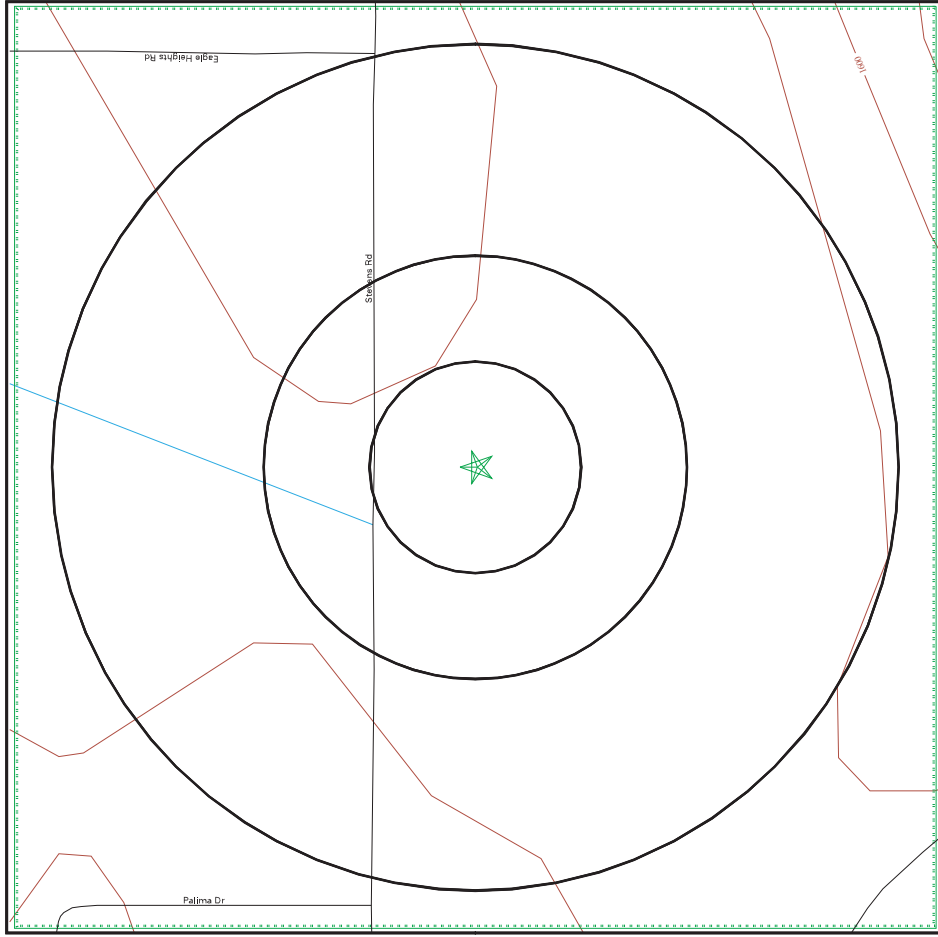

## FLOOD PLAIN MAP FINDINGS

Source: FEMA DFIRM Flood Data, FEMA Q3 Flood Data

County: JACKSON, OR      FEMA flood data electronic coverage: YES

Flood Plain panel at target property: 4155890317B (FEMA Q3 Flood data)  
 Additional Flood Plain panel(s) in search area: 4155890309B (FEMA Q3 Flood data)

## National Wetlands Inventory Map

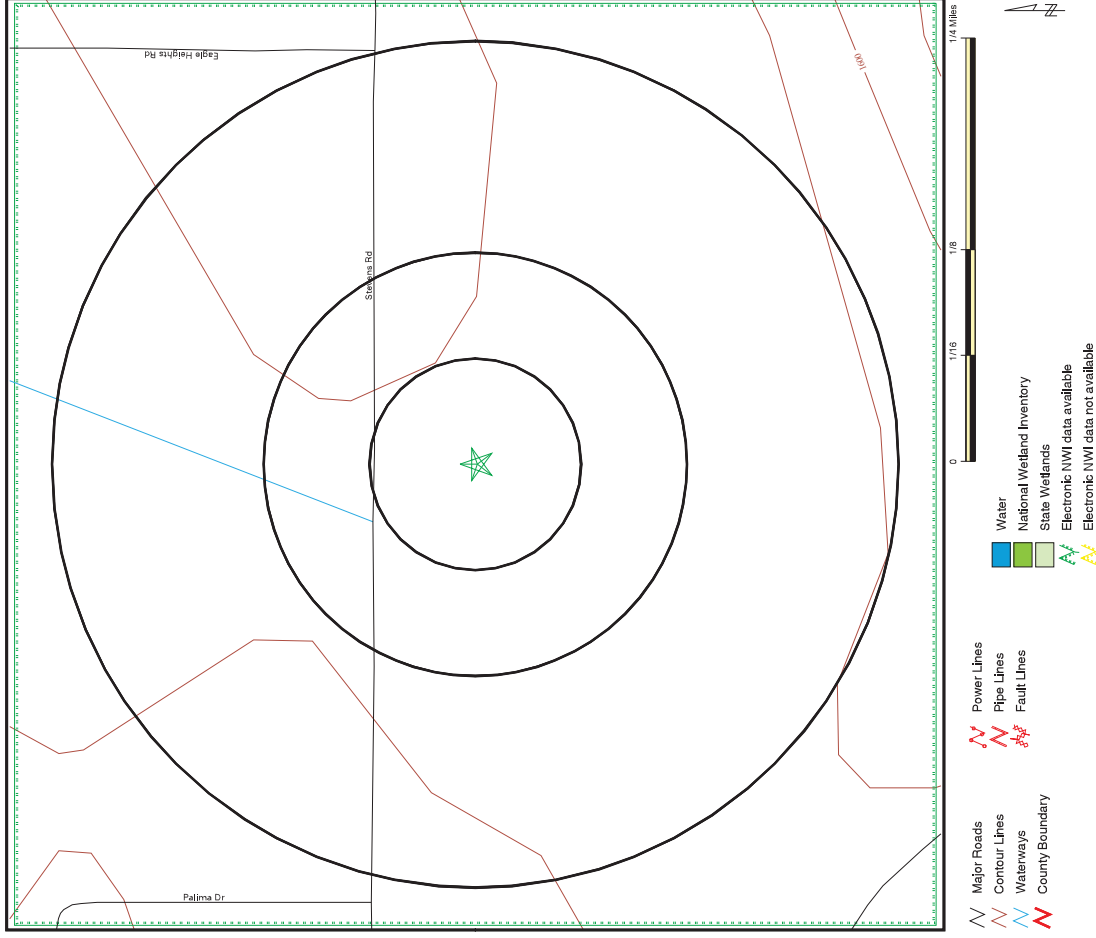

SITE NAME: ---  
 ADDRESS: 2763 RILEY ROAD  
 Eagle Point, OR 97524  
 LAT/LONG: 42.46687 -122.7821

CLIENT: Department of Veterans Affairs  
 CONTACT: na  
 INQUIRY #: Online\_Report  
 DATE: TC/Online\_Report.Pag

Copyright © 2010 ERI, Inc. © 2010 TAP Atlas PVI, 075908.

## WETLANDS MAP FINDINGS

Source: Fish and Wildlife Service NWI data  
 NWI hardcopy map at target property: Eagle Point  
 Additional NWI hardcopy map(s) in search area:  
 Not reported in source data

Map ID	Direction	Distance	Code and Description*	Database
--------	-----------	----------	-----------------------	----------

No Sites Reported.

## WETLANDS CLASSIFICATION SYSTEM

National Wetland Inventory Maps are produced by the U.S. Fish and Wildlife Service, a sub-department of the U.S. Department of the Interior. In 1974, the U.S. Fish and Wildlife Service developed a criteria for wetland classification with four long range objectives:

- to describe ecological units that have certain homogeneous natural attributes,
- to arrange these units in a system that will aid decisions about resource management,
- to furnish units for inventory and mapping, and
- to provide uniformity in concepts and terminology throughout the U.S.

High altitude infrared photographs, soil maps, topographic maps and site visits are the methods used to gather data for the productions of these maps. In the infrared photos, wetlands appear as different colors and these wetlands are then classified by type. Using a hierarchical classification, the maps identify wetland and deepwater habitats according to:

- system
- subsystem
- class
- subclass
- modifiers

(as defined by Cowardin, et al. U.S. Fish and Wildlife Service FWS/OBS 79/31. 1979.)

The classification system consists of five systems:

1. marine
2. estuarine
3. riverine
4. lacustrine
5. palustrine

The marine system consists of deep water tidal habitats and adjacent tidal wetlands. The riverine system consists of all wetlands contained within a channel. The lacustrine system includes all nontidal wetlands related to swamps, bogs & marshes. The estuarine system consists of deepwater tidal habitats and where ocean water is diluted by fresh water. The palustrine system includes nontidal wetlands dominated by trees and shrubs and where salinity is below .5% in tidal areas. All of these systems are divided in subsystems and then further divided into class.

National Wetland Inventory Maps are produced by transferring gathered data on a standard 7.5 minute U.S.G.S. topographic map. Approximately 52 square miles are covered on a National Wetland Inventory map at a scale of 1:24,000. Electronic data is compiled by digitizing these National Wetland Inventory Maps.

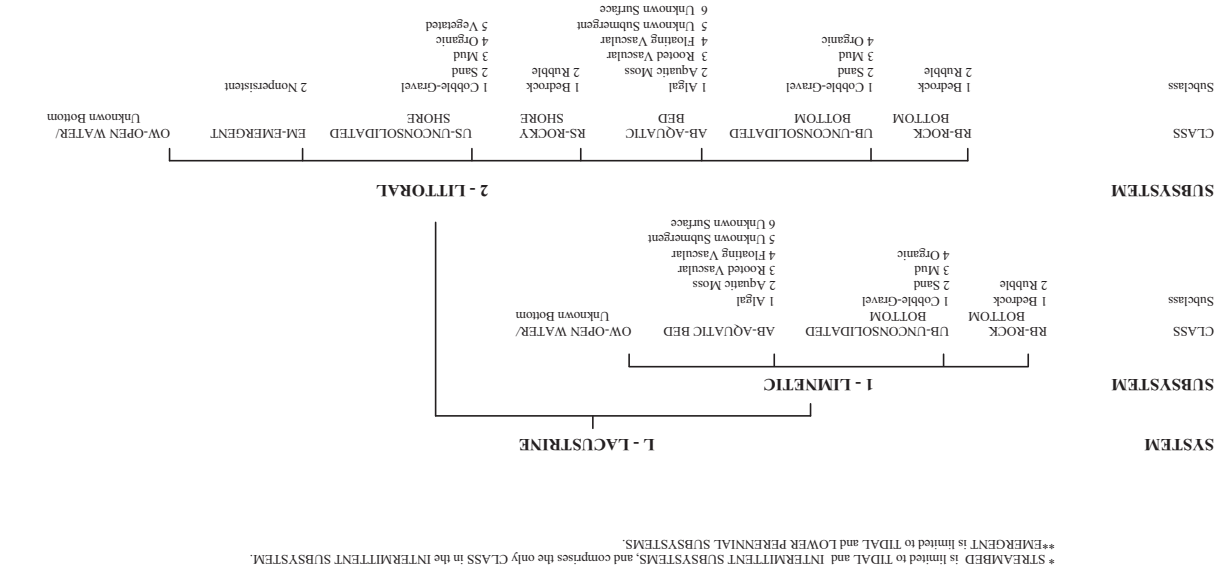

\*STREAMBED is limited to TIDAL and INTERMITTENT SUBSYSTEMS, and comprises the only CLASS in the INTERMITTENT SUBSYSTEM. \*\*EMERGENT is limited to TIDAL and LOWER PERENNIAL SUBSYSTEMS.

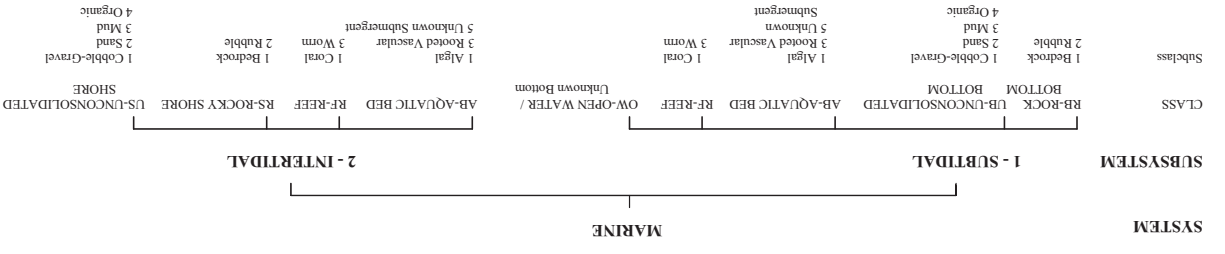
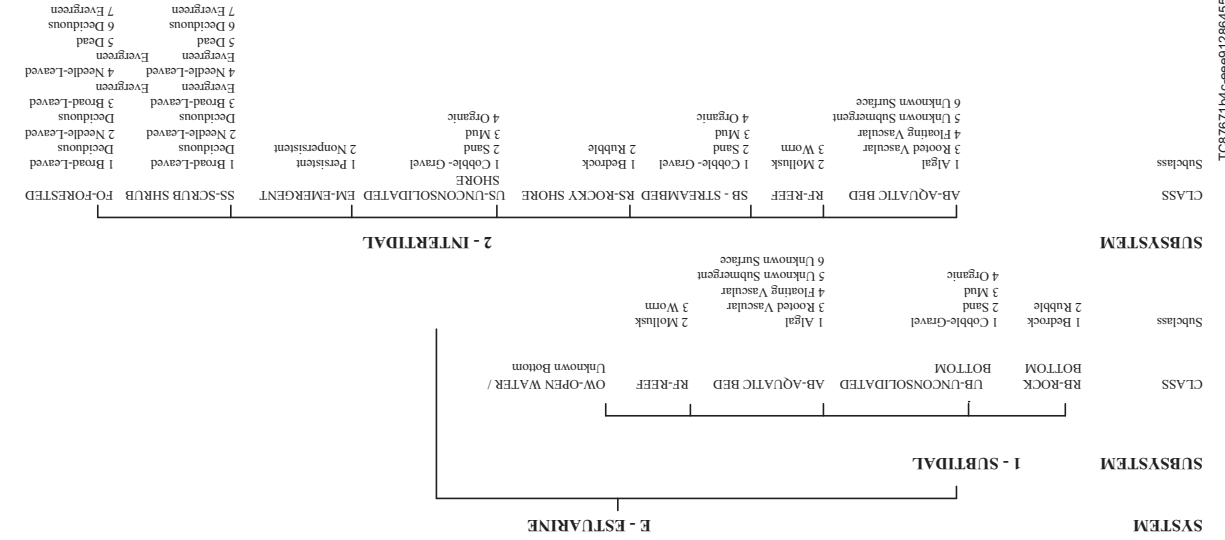
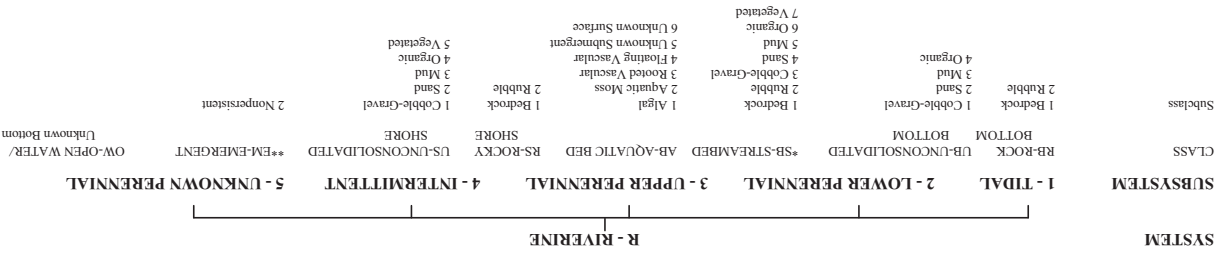

# FCC & FAA Sites Map

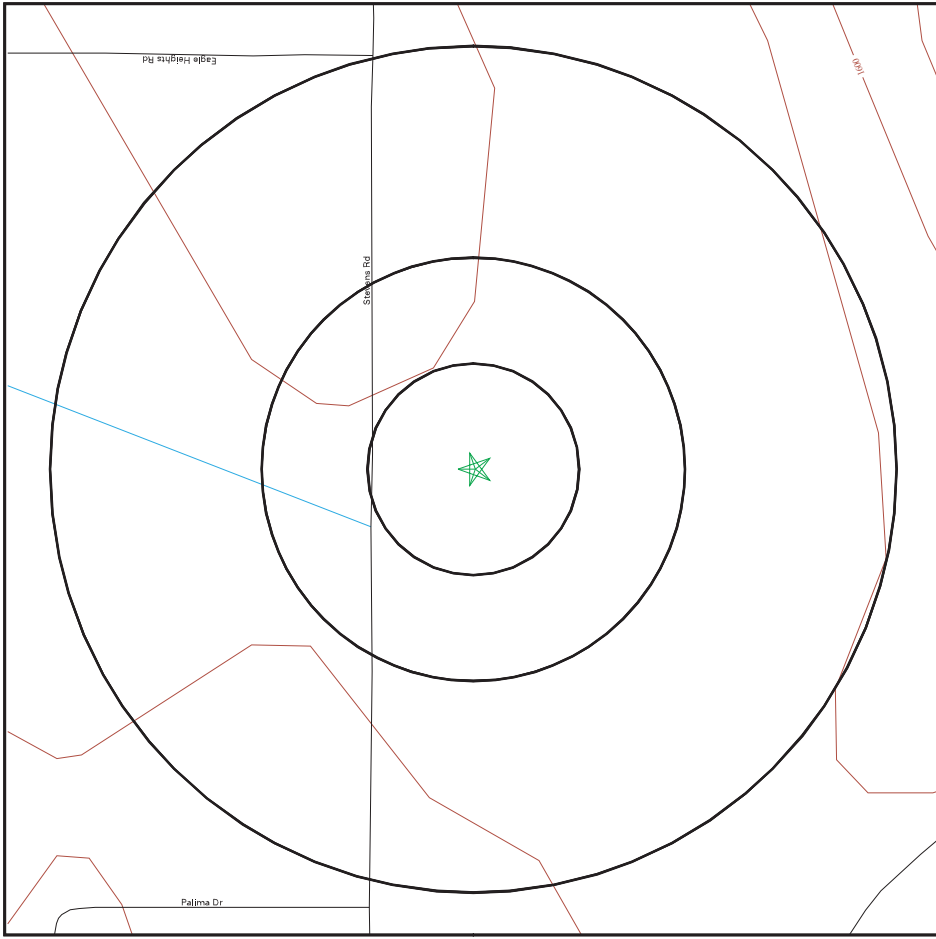

**SITE NAME:** 2763 RILEY ROAD  
**ADDRESS:** Eagle Point OR 97524  
**LAT/LONG:** 42.4665 1-122.7821

**CLIENT:** Department of Veterans Affairs  
**CONTACT:** na  
**INQUIRY #:** Online\_Report  
**DATE:** TC\Online\_Report.Pag

Copyright © 2010 ERI, Inc. © 2010 Top Atlas Inc. 075908

MODIFIERS	
In order to more adequately describe wetland and deepwater habitats one or more of the water regime, water chemistry, soil, or special modifiers may be applied at the class or lower level in the hierarchy. The named modifier may also be applied to the ecological system.	
WATER REGIME	WATER CHEMISTRY
A Temporarily Flooded B Saturated C Seasonally Flooded D Seasonally Flooded/ Well Drained E Seasonally Flooded/ Saturated F Saturated G Intermittently Exposed H Permanently Flooded I Intermittently Flooded J Artificially Flooded K Artificially Flooded L Subtidal M Regularly Exposed N Regularly Flooded O Regularly Flooded/ Saturated/Semipermanent/ P Irregularly Flooded Q Irregularly Flooded/ Saturated R Seasonal-Tidal S Temporal-Tidal T Semipermanent-Tidal U Unknown V Permanent-Tidal W Intermittently X Artificially Flooded/ Saturated Y Saturated/Semipermanent/ Flooded/Temporary Z Intermittently Exposed/Permanent *These water regimes are only used in tidally influenced, freshwater systems.	1 Hypersaline 2 Euhaline 3 Mixohaline (Brackish) 4 Polyhaline 5 Mesohaline 6 Oligohaline 7 Hypersaline 8 Euhaline 9 Mixohaline 0 Fresh a Acid b Neutral c Circumneutral d Alkaline e Organic f Mineral g Artificial Substrate h Spoil i Excavated
NON-TIDAL	TIDAL
1 Algal 2 Aquatic Moss 3 Rooted Vascular 4 Floating Vascular 5 Unknown 6 Submerged 7 Unknown Surface	1 Moss 2 Lichen 3 Sand 4 Cobble-Gravel 5 Vegetated 6 Unknown Surface

SUBSYSTEM	
CLASS RB-ROCK BOTTOM UB-UNCONSOLIDATED BOTTOM AB-AQUATIC BED US-UNCONSOLIDATED SHORE ML-LOSS-LICHEN EM-EMERGENT SS-SCRUB-SHRUB FO-FORESTED OW-OPEN WATER/Unknown	Subclass 1 Bedrock 2 Rubble 3 Sand 4 Cobble-Gravel 1 Algal 2 Aquatic Moss 3 Rooted Vascular 4 Floating Vascular 5 Unknown 6 Submerged 7 Unknown Surface 1 Moss 2 Lichen 3 Sand 4 Cobble-Gravel 5 Vegetated 6 Unknown Surface 1 Broad-Leaved Deciduous 2 Needle-Leaved Deciduous 3 Broad-Leaved Deciduous 4 Needle-Leaved Evergreen 5 Dead Evergreen 6 Deciduous Evergreen 7 Evergreen

Source: U.S. Department of the Interior  
Fish and Wildlife Service  
National Wetlands Inventory

**FCC & FAA SITES MAP FINDINGS  
TOWERS**

Map ID  
Direction  
Distance  
Distance (ft)

EDR ID  
Database

No Sites Reported.

**FCC & FAA SITES MAP FINDINGS  
AIRPORTS**

EDR ID  
Database

No Sites Reported.

## FCC & FAA SITES MAP FINDINGS POWERLINES

EDR ID  
Database

No Sites Reported.

## KEY CONTACTS & GOVERNMENT RECORDS SEARCHED

Various Federal laws and executive orders address specific environmental concerns. NEPA requires the responsible offices to integrate to the greatest practical extent the applicable procedures required by these laws and executive orders. EDR provides key contacts at agencies charged with implementing these laws and executive orders to supplement the information contained in this report.

### NATURAL AREAS

#### Officially designated wilderness areas

Government Records Searched in [This Report](#)

FED\_LAND: Federal Lands

Source: USGS

Telephone: 703-648-5094

Federal data from Bureau of Land Management, National Park Service, Forest Service, and Fish and Wildlife Service.

- National Parks
  - Forests
  - Monuments
  - Wildlife Sanctuaries, Preserves, Refuges
  - Federal Wilderness Areas.
- Date of Government Version: 12/31/2005

#### Federal Contacts for Additional Information

National Park Service, Pacific West Region  
600 Harrison Street, Suite 600  
San Francisco, CA 94107  
415-427-1300

USDA Forest Service, Pacific Northwest  
333 SW First Street P.O. Box 3623  
Portland, OR 97208  
503-326-3865

BLM - Oregon State Office  
1515 SW 5th Ave.  
Portland, OR 97208-2965  
503-952-6002

Fish & Wildlife Service, Region 1  
Eastside Federal Complex 911 NE 11th Avenue  
Portland, OR 97232-4181  
503-231-6188

#### Officially designated wildlife preserves, sanctuaries and refuges

Government Records Searched in [This Report](#)

FED\_LAND: Federal Lands

Source: USGS

Telephone: 703-648-5094

Federal data from Bureau of Land Management, National Park Service, Forest Service, and Fish and Wildlife Service.

- National Parks
  - Forests
  - Monuments
  - Wildlife Sanctuaries, Preserves, Refuges
  - Federal Wilderness Areas.
- Date of Government Version: 12/31/2005

## KEY CONTACTS & GOVERNMENT RECORDS SEARCHED

OR BLM Owned Lands: BLM Owned Lands  
Bureau of Land Management owned lands in the state of Oregon  
Source: State Center for GIS.  
Telephone: 503-378-2166

### Federal Contacts for Additional Information

Fish & Wildlife Service, Region 1  
Eastside Federal Complex 911 NE 11th Avenue  
Portland, OR 97232-4181  
503-231-6188

### State Contacts for Additional Information

Dept. of Fish and Wildlife 503-872-5272

### **Wild and scenic rivers**

#### Government Records Searched in This Report

FED\_LAND: Federal Lands

Source: USGS

Telephone: 703-648-5094

Federal data from Bureau of Land Management, National Park Service, Forest Service, and Fish and Wildlife Service.

- National Parks

- Forests

- Monuments

- Wildlife Sanctuaries, Preserves, Refuges

- Federal Wilderness Areas

Date of Government Version: 12/31/2005

### Federal Contacts for Additional Information

Fish & Wildlife Service, Region 1

Eastside Federal Complex 911 NE 11th Avenue

Portland, OR 97232-4181

503-231-6188

### **Endangered species**

#### Government Records Searched in This Report

Endangered Species Protection Program Database

A listing of endangered species by county.

Source: Environmental Protection Agency

Telephone: 703-305-5239

### Federal Contacts for Additional Information

Fish & Wildlife Service, Region 1

Eastside Federal Complex 911 NE 11th Avenue

Portland, OR 97232-4181

503-231-6188

### State Contacts for Additional Information

Natural Heritage Program 503-731-3070

## KEY CONTACTS & GOVERNMENT RECORDS SEARCHED

### **LANDMARKS, HISTORICAL, AND ARCHEOLOGICAL SITES**

#### Historic Places

Government Records Searched in This Report

National Register of Historic Places:

The National Register of Historic Places is the official federal list of districts, sites, buildings, structures, and objects significant in American history, architecture, archeology, engineering, and culture. These contribute to an understanding of the historical and cultural foundations of the nation. The National Register includes:

- All prehistoric and historic units of the National Park System;
- National Historic Landmarks, which are properties recognized by the Secretary of the Interior as possessing national significance; and
- Properties significant in American, state, or local prehistory and history that have been nominated by State Historic Preservation Officers, federal agencies, and others, and have been approved for listing by the National Park Service.

Date of Government Version: 03/23/2006

OR Historic Sites: National Register Database

Source: Parks and Recreation Department. State Historic Preservation Office

Telephone: 503-378-6305

### Federal Contacts for Additional Information

Park Service; Advisory Council on Historic Preservation

1849 C Street NW

Washington, DC 20240

Phone: (202) 208-6843

### State Contacts for Additional Information

State Parks & Recreation Department 503-378-5019

### **Indian Religious Sites**

#### Government Records Searched in This Report

Indian Reservations:

This map layer portrays Indian administrated lands of the United States that have any area equal to or greater than 640 acres.

Source: USGS

Phone: 888-275-8747

Date of Government Version: 12/31/2005

### Federal Contacts for Additional Information

Department of the Interior- Bureau of Indian Affairs

Office of Public Affairs

1849 C Street, NW

Washington, DC 20240-0001

Office: 202-208-3711

Fax: 202-501-1516

National Association of Tribal Historic Preservation Officers

1411 K Street NW, Suite 700

Washington, DC 20005

Phone: 202-628-8476

Fax: 202-628-2241

## KEY CONTACTS & GOVERNMENT RECORDS SEARCHED

State Contacts for Additional Information  
A listing of local Tribal Leaders and Bureau of Indian Affairs Representatives can be found at:  
<http://www.doi.gov/bia/areas/agency.html>

Portland Area Office, Bureau of Indian Affairs  
911 N.E. 11th Avenue  
Portland, OR 97232  
503-231-6702

Confederated Tribes of the Umatilla Reservation  
P. O. Box 638  
Pendleton, OR 97801

Confederated Tribes of Warm Springs  
P. O. Box C  
Warm Springs, OR 97761

### Scenic Trails

State Contacts for Additional Information  
Pacific Crest Trail Association  
5325 Elkhorn Boulevard, #256  
Sacramento, California 95842  
916-349-2109

### FLOOD PLAIN, WETLANDS AND COASTAL ZONE

**Flood Plain Management**  
Government Records Searched in This Report  
Flood Zone Data: This data, available in select counties across the country, was obtained by EDR in 2003 & 2009 from the Federal Emergency Management Agency (FEMA). Data depicts 100-year and 500-year flood zones as defined by FEMA.

Federal Contacts for Additional Information  
Federal Emergency Management Agency 877-3362-627  
State Contacts for Additional Information  
Dept. of State Police, Emergency Management 503-378-2911

### Wetlands Protection

Government Records Searched in This Report  
NWI: National Wetlands Inventory. This data, available in select counties across the country, was obtained by EDR in 2004 from the U.S. Fish and Wildlife Service.

State Wetlands Data: Wetlands Inventory Data  
Source: Oregon Geospatial Enterprise Office  
Telephone: 503-378-2166

Federal Contacts for Additional Information  
Fish & Wildlife Service 813-570-5412

State Contacts for Additional Information  
Dept. of Fish & Wildlife 503-872-5272

## KEY CONTACTS & GOVERNMENT RECORDS SEARCHED

**Coastal Zone Management**  
Government Records Searched in This Report  
CALWA Management Areas  
Dept. of Env., Health & Natural Resources  
919-733-2293

Federal Contacts for Additional Information  
Office of Ocean and Coastal Resource Management  
N/ORM, SSMC4  
1305 East-West Highway  
Silver Spring, Maryland 20910  
301-713-3102

State Contacts for Additional Information  
Coastal & Ocean Mgmt. Program, Dept. of Land Conservation & Development 503-731-4065

### FCC & FAA SITES MAP

For NEPA actions that come under the authority of the FCC, the FCC requires evaluation of Antenna towers and/or supporting structures that are to be equipped with high intensity white lights which are to be located in residential neighborhoods, as defined by the applicable zoning law.

Government Records Searched in This Report

**Cellular**  
Federal Communications Commission  
445 12th Street, SW  
Washington, DC 20554  
888-225-5322

### 4G Cellular

Federal Communications Commission  
445 12th Street, SW  
Washington, DC 20554  
888-225-5322

### Antenna Structure Registration

Federal Communications Commission  
445 12th Street, SW  
Washington, DC 20554  
888-225-5322

### Towers

Federal Communications Commission  
445 12th Street, SW  
Washington, DC 20554  
888-225-5322

### AM Antenna

Federal Communications Commission  
445 12th Street, SW  
Washington, DC 20554  
888-225-5322

## KEY CONTACTS & GOVERNMENT RECORDS SEARCHED

**FM Antenna**  
Federal Communications Commission  
445 12th Street, SW  
Washington, DC 20554  
888-225-5322

**FAA Digital Obstacle File**  
Federal Aviation Administration (FAA)  
1305 East-West Highway, Station 5631  
Silver Spring, MD 20910-3281  
Telephone: 301-713-2817  
Describes known obstacles of interest to aviation users in the US. Used by the Federal Aviation Administration (FAA) and the National Oceanic and Atmospheric Administration to manage the National Airspace System.

**Airport Landing Facilities**  
Federal Aviation Administration  
Telephone (800) 457-6656  
Private and public use landing facilities.

**Electric Power Transmission Line Data**  
Rexing Strategies Corp.  
14405 Walters Road, Suite 510  
Houston, TX 77014  
281-769-2247  
U.S. Electric Transmission and Power Plants systems Digital GIS Data.

**Excessive Radio Frequency Emission**  
For NEPA actions that come under the authority of the FCC, Commission actions granting construction permits, licenses to transmit or renewals thereof, equipment authorizations or modifications in existing facilities, require the determination of whether the particular facility, operation or transmitter would cause human exposure to levels of radio frequency in excess of certain limits.

**Federal Contacts for Additional Information**  
Office of Engineering and Technology  
Federal Communications Commission  
445 12th Street SW  
Washington, DC 20554  
Phone: 202-418-2470

### OTHER CONTACT SOURCES

#### STREET AND ADDRESS INFORMATION

(c) 2010 Tele Atlas North America, Inc. All rights reserved. This material is proprietary and the subject of copyright protection and other intellectual property rights owned by or licensed to Tele Atlas North America, Inc. The use of this material is subject to the terms of a license agreement. You will be held liable for any unauthorized copying or disclosure of this material.

## EDR VISTACheck® Report

Department of Veterans Affairs  
2763 RILEY ROAD  
Eagle Point, OR 97524

Latitude (North): 42.466475 - 42°27'59.31"  
Longitude (West): 122.782143 - 122°46'55.7148"

October 07, 2010



**Nationwide Customer Service**  
Telephone: 1-800-352-0050  
Internet: www.edrnet.com

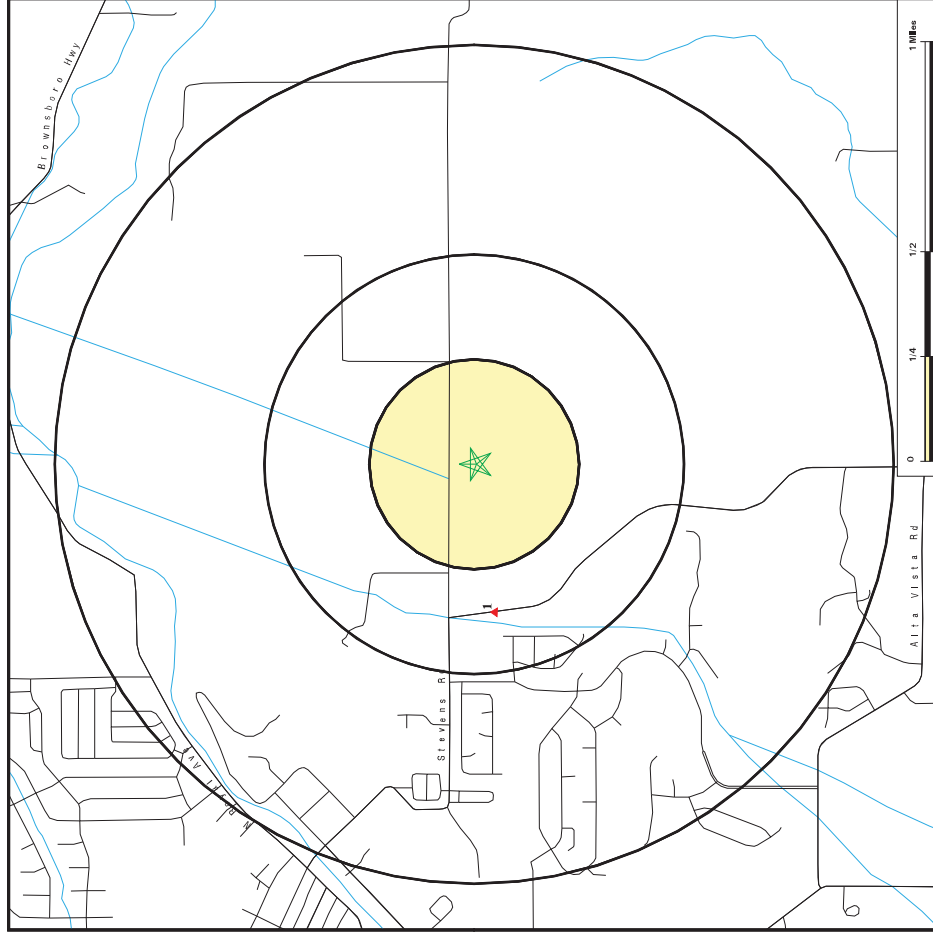

★ Target Property  
▲ Toxic Sites  
National Priority List Sites  
Dept. Defense Sites  
Indian Reservations BIA

# EDR VISTACheck® Report

SECTION	PAGE
Map Findings Summary	3
Map Findings	6
Orphan Summary	7

## MAP FINDINGS SUMMARY

Database	Target Property	Search Distance (Miles)	< 1/8	1/8 - 1/4	1/4 - 1/2	1/2 - 1	> 1	Total Plotted
----------	-----------------	-------------------------	-------	-----------	-----------	---------	-----	---------------

### STANDARD ENVIRONMENTAL RECORDS

<b>Federal/NPL site list</b>								
NPL		0.500	0	0	0	NR	NR	0
Proposed NPL		0.500	0	0	0	NR	NR	0
NPL LIENS	TP		NR	NR	NR	NR	NR	0
<b>Federal/Delisted NPL site list</b>								
Delisted NPL		0.500	0	0	0	NR	NR	0
<b>Federal CERCLIS list</b>								
CERCLIS		0.500	0	0	0	NR	NR	0
FEDERAL FACILITY		1.000	0	0	0	0	NR	0
<b>Federal CERCLIS NFRAP site List</b>								
CERC-NFRAP		0.500	0	0	0	NR	NR	0
<b>Federal RCRA CORRACTS facilities list</b>								
CORRACTS		0.500	0	0	0	NR	NR	0
<b>Federal RCRA non-CORRACTS TSD facilities list</b>								
RCRA-TSDF		0.500	0	0	0	NR	NR	0
<b>Federal RCRA generators list</b>								
RCRA-LQG		0.250	0	0	NR	NR	NR	0
RCRA-SQG		0.250	0	0	NR	NR	NR	0
RCRA-CESQG		0.250	0	0	NR	NR	NR	0
<b>Federal institutional controls / engineering controls registries</b>								
US ENG. CONTROLS		0.500	0	0	0	NR	NR	0
US INST CONTROL		0.500	0	0	0	NR	NR	0
<b>Federal ERNS list</b>								
ERNS	TP		NR	NR	NR	NR	NR	0
<b>State- and tribal - equivalent NPL</b>								
ECSI		0.500	0	0	0	NR	NR	0
<b>State- and tribal - equivalent CERCLIS</b>								
OR CRL		0.500	0	0	0	NR	NR	0
<b>State and tribal landfill and/or solid waste disposal site lists</b>								
SWF/LF		0.500	0	0	0	NR	NR	0
<b>State and tribal leaking storage tank lists</b>								
LUST		0.500	0	0	1	NR	NR	1
INDIAN LUST		0.500	0	0	0	NR	NR	0

### Disclaimer - Copyright and Trademark Notice

This Report contains certain information obtained from a variety of public and other sources reasonably available to Environmental Data Resources, Inc. ("EDR") or its affiliates. EDR and its affiliates do not warrant the accuracy, completeness, or timeliness of the information provided in this report. Environmental Data Resources, Inc. specifically disclaims the making of any such warranties, including without limitation, merchantability or fitness for a particular use or purpose. All risk is assumed by the user. In no event shall Environmental Data Resources, Inc. be liable to anyone, whether arising out of errors or omissions, negligence, accident or any other cause, for any loss of damage, including, without limitation, special, incidental, or consequential damages, of any kind or nature, in the past or future, arising out of the use of this report. The amount paid for this report is the full and final amount paid for this report. Environmental Data Resources, Inc. is strictly limited to a refund of the amount paid for this report, provided that the user returns the report to EDR within 30 days of the date of purchase. Environmental risk levels or risk codes provided in this report are provided for illustrative purposes only, and are not intended to provide, nor should they be interpreted as providing any facts regarding, or prediction or forecast of, any environmental risk for any property. Only a Phase I Environmental Site Assessment performed by an environmental professional can provide information regarding the environmental risk for any property. Additionally, the information provided in this report is not to be construed as legal advice.

Copyright 2010 by Environmental Data Resources, Inc. All rights reserved. Reproduction in any media or format, in whole or in part, of any report or map of Environmental Data Resources, Inc., or its affiliates, is prohibited without prior written permission. EDR and its logos (including Sanborn and Sanborn Map) are trademarks of Environmental Data Resources, Inc. or its affiliates. All other trademarks used herein are the property of their respective owners.

173b517b-f9ac-4b10-bdd8-99287300e90b

MAP FINDINGS SUMMARY

Database	Target Property	Search Distance (Miles)	< 1/8	1/8 - 1/4	1/4 - 1/2	1/2 - 1	> 1	Total Plotted
<b>State and tribal registered storage tank lists</b>								
UST		0.250	0	0	NR	NR	NR	0
AST		0.250	0	0	NR	NR	NR	0
INDIAN UST		0.250	0	0	NR	NR	NR	0
FEMA UST		0.250	0	0	NR	NR	NR	0
<b>State and tribal institutional control / engineering control registries</b>								
ENG CONTROLS		0.500	0	0	NR	NR	NR	0
INST CONTROL		0.500	0	0	NR	NR	NR	0
<b>State and tribal voluntary cleanup sites</b>								
VCP		0.500	0	0	NR	NR	NR	0
INDIAN VCP		0.500	0	0	NR	NR	NR	0
<b>State and tribal Brownfields sites</b>								
BROWNFIELDS		0.500	0	0	NR	NR	NR	0
<b>ADDITIONAL ENVIRONMENTAL RECORDS</b>								
<b>Local Brownfield lists</b>								
US BROWNFIELDS		0.500	0	0	NR	NR	NR	0
<b>Local Lists of Landfill / Solid Waste Disposal Sites</b>								
DEBRIS REGION 9		0.500	0	0	NR	NR	NR	0
ODI		0.500	0	0	NR	NR	NR	0
HIST LF		0.500	0	0	NR	NR	NR	0
<b>Local Lists of Hazardous waste / Contaminated Sites</b>								
US CDL		TP	NR	NR	NR	NR	NR	0
AOCNCERN		0.500	0	0	NR	NR	NR	0
CDL		TP	NR	NR	NR	NR	NR	0
US HIST CDL		TP	NR	NR	NR	NR	NR	0
<b>Local Land Records</b>								
LIENS 2		TP	NR	NR	NR	NR	NR	0
LUCIS		0.500	0	0	NR	NR	NR	0
<b>Records of Emergency Release Reports</b>								
HMIRS		TP	NR	NR	NR	NR	NR	0
SPILLS		TP	NR	NR	NR	NR	NR	0
<b>Other Ascertainable Records</b>								
RCRA-NonGen		TP	NR	NR	NR	NR	NR	0
DOT OPS		TP	NR	NR	NR	NR	NR	0
DOD		0.500	0	0	NR	NR	NR	0
FUDS		0.500	0	0	NR	NR	NR	0

MAP FINDINGS SUMMARY

Database	Target Property	Search Distance (Miles)	< 1/8	1/8 - 1/4	1/4 - 1/2	1/2 - 1	> 1	Total Plotted
<b>EDR PROPRIETARY RECORDS</b>								
<b>EDR Proprietary Records</b>								
Manufactured Gas Plants		0.500	0	0	0	NR	NR	0
EDR Historical Auto Stations		0.250	0	0	NR	NR	NR	0
EDR Historical Cleaners		0.250	0	0	NR	NR	NR	0
<b>NOTES:</b>								
TP = Target Property								
NR = Not Requested at this Search Distance								
Sites may be listed in more than one database								

Map ID  
 Direction  
 Distance  
 Distance (ft.) Site

MAP FINDINGS

EPA ID Number  
 Database(s)

U000437102  
 N/A

1 FORT ROCK SUBSTATION  
 West ARROW GAP RD 97638  
 0.356 mi.  
 1878 ft.

LUST:

Region: Western Region  
 Facility ID: 15-91-0011  
 Cleanup Received Date: 2/16/1991  
 Cleanup Start Date: 2/14/1991  
 Cleanup Complete Date: 2/26/1991

UST:

Facility ID: 8012  
 Facility Telephone: (509)522-6239  
 Permittee Name: ORION L. ALBRO, AREA OFFICE SUPT.  
 Number of Permitted Tanks: Not reported  
 Active Tanks: Not reported  
 Decommissioned Tanks: 3  
 Number of Tanks: 3

97524 UST  
 97524 UST  
 97524 FINS, ECST  
 97524 MINES

30000 OF HWY E  
 OLD & S ROYAL AVE  
 HWY 140 PIT

U004016054 FISH LAKE RESORT  
 S105856217 FISH LAKE RESORT  
 100685431 ROGUE AGGREGATES, INC.  
 M300001103

EAGLE POINT  
 EAGLE POINT  
 JACKSON COUNTY

ORPHAN SUMMARY

2763 RILEY ROAD  
Eagle Point, OR 97524

October 7, 2010

## EDR Offsite Receptor Report

440 Wheelers Farms Road  
Milford, CT 06461  
Toll Free: 800.352.0050  
www.edrmat.com



## TABLE OF CONTENTS

SECTION	PAGE
Executive Summary	2
Census Map	3
Census Findings	4
Receptor Map	5
Map Findings	6
Records Searched/Data Currency Tracking Addendum	9

**Thank you for your business**  
Please contact EDR at 1-800-352-0050  
with any questions or comments.

### Disclaimer - Copyright and Trademark Notice

This Report contains certain information obtained from a variety of public and other sources reasonably available to Environmental Data Resources, Inc. Environmental Data Resources, Inc. does not warrant the accuracy, completeness or timeliness of the information contained herein and makes no warranty, expressed or implied, in connection with this report. ENVIRONMENTAL DATA RESOURCES, INC. SPECIFICALLY DISCLAIMS THE MAKING OF ANY SUCH WARRANTIES, INCLUDING WITHOUT LIMITATION, MERCHANTABILITY OR FITNESS FOR A PARTICULAR USE OR PURPOSE. ALL RISK IS ASSUMED BY THE USER. IN NO EVENT SHALL ENVIRONMENTAL DATA RESOURCES, INC. BE LIABLE TO ANYONE, WHETHER ARISING OUT OF ERRORS OR OMISSIONS, NEGLIGENCE, ACCIDENT OR ANY OTHER CAUSE, FOR ANY LOSS OF DAMAGE, INCLUDING WITHOUT LIMITATION, SPECIAL, INCIDENTAL, CONSEQUENTIAL DAMAGES, PUNITIVE DAMAGES OR THE LOSS OF PROFITS, REVENUE, BUSINESS OR ANY OTHER LOSS, INCLUDING LIMITED TO A FEE OF THE AMOUNT PAID FOR THIS REPORT. THE FACTS OR CODES IN THIS REPORT, AS WELL AS THE RISK RATINGS, environmental risk levels or risk codes provided in this Report are provided for illustrative purposes only, and are not intended to provide, nor should they be interpreted as providing any facts regarding, or prediction or forecast of, any environmental risk for any property. Only a Phase I Environmental Site Assessment performed by an environmental professional can provide information regarding the environmental risk for any property. Additionally, the information provided in this Report is not to be construed as legal advice.

Copyright 2010 by Environmental Data Resources, Inc. All rights reserved. Reproduction in any media or format, in whole or in part, of any report or map of Environmental Data Resources, Inc., or its affiliates, is prohibited without prior written permission. EDR and its logos (including Sanborn and Sanborn Map) are trademarks of Environmental Data Resources, Inc. or its affiliates. All other trademarks used herein are the property of their respective owners.

## EXECUTIVE SUMMARY

A search of available records was conducted by Environmental Data Resources, Inc. (EDR). The EDR Offsite Receptor Report provides information which may be used to comply with the Clean Air Act Risk Management Program 112-R. *"The rule requires that your estimate in the RMP residential populations within the circle defined by the endpoint for your worst-case and alternative release scenarios (i.e., the center of the circle is the point of release and the radius is the distance to the endpoint). In addition, you must report in the RMP whether certain types of public receptors and environmental receptors are within the circles."*

The address of the subject property, for which the search was intended, is:

2763 RILEY ROAD  
EAGLE POINT, OR 97524

Distance Searched: 1,000 miles from subject property

### RECEPTOR SUMMARY

An X indicates the presence of the receptor within the search radius.

### Residential Population

Estimated population within search radius: 684 persons.

### Other Public Receptors

Type	Within Search Radius	Sites Total
Day Care Centers:	<input checked="" type="checkbox"/>	3
Medical Centers:	<input type="checkbox"/>	
Nursing Homes:	<input type="checkbox"/>	
Schools:	<input type="checkbox"/>	
Hospitals:	<input checked="" type="checkbox"/>	1
Colleges:	<input type="checkbox"/>	
Arena:	<input type="checkbox"/>	
Prison:	<input type="checkbox"/>	

### Environmental Receptors

Type	Within Search Radius	Sites Total
Federal Land:	<input type="checkbox"/>	

CENSUS MAP - 91ed1d8e-75331286455770892

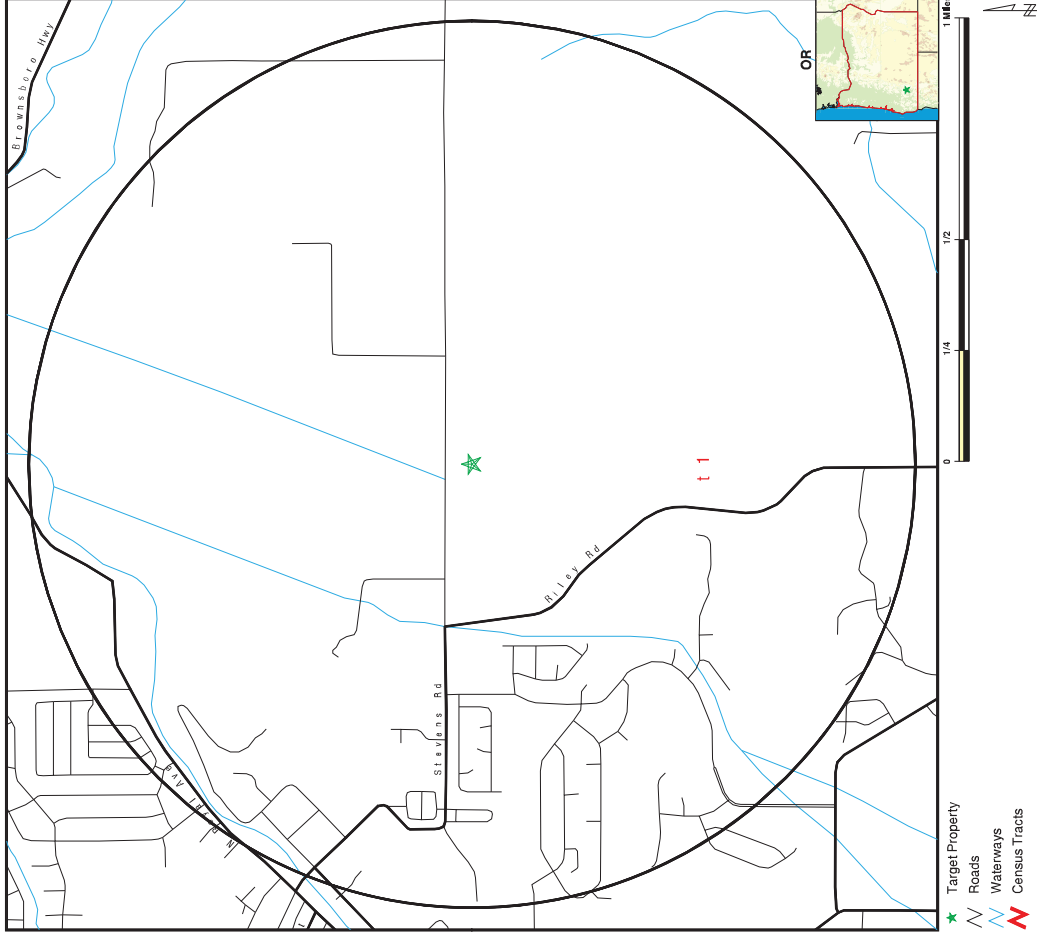

TARGET PROPERTY:  
ADDRESS: 2763 RILEY ROAD  
CITY/STATE/ZIP: Eagle Point OR 97524  
LAT/LONG: 42.46657-122.7821

CUSTOMER: Department of Veterans Affairs  
CONTACT: na  
INQUIRY #: Online Report  
DATE: October 07, 2010 8:49 am

Copyright © 2010 EDR, Inc. © 2010 The Atlas社. 075096

### CENSUS FINDINGS

Map ID	Total Population	Population in Radius	Total Area(sq.mi.)	Area in Radius(sq.mi.)
T1	0014.00	6808	31.09	3.13

### RECEPTOR MAP - 91ed1d8e-75331286455770892

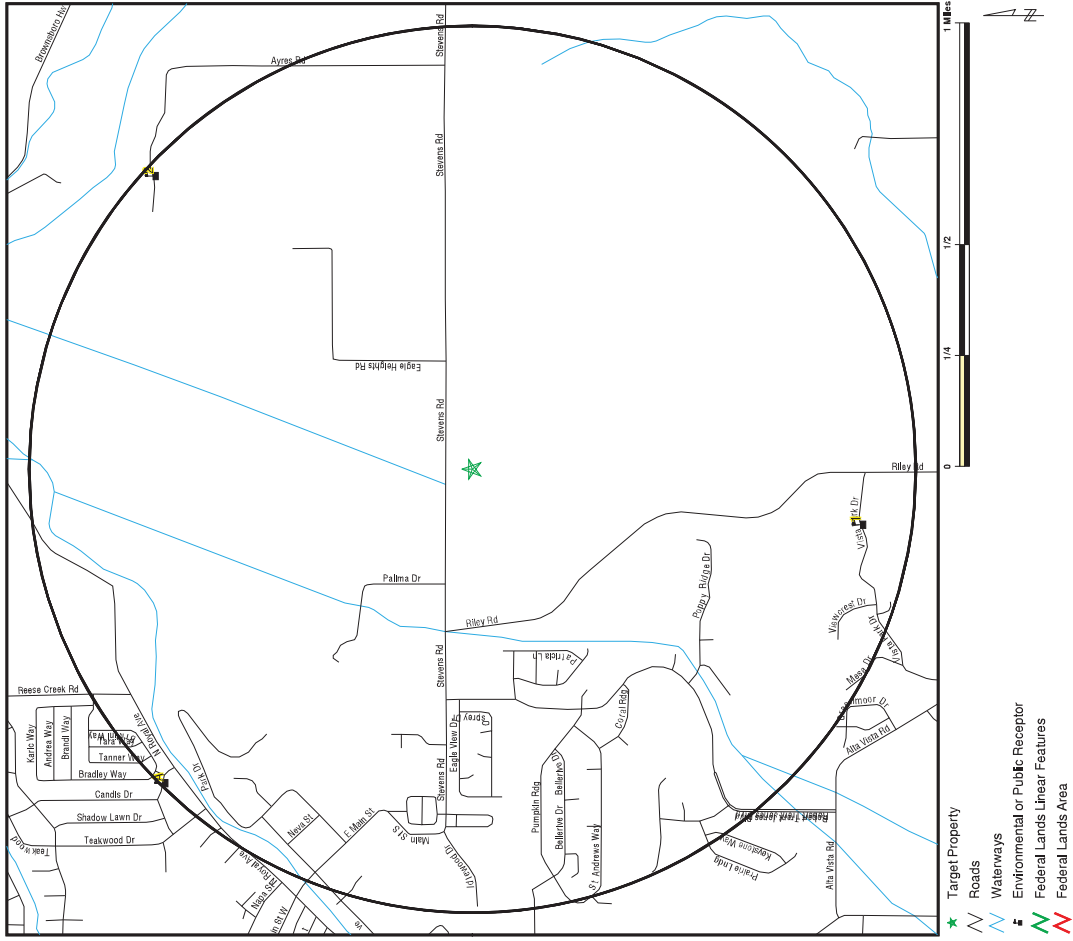

**TARGET PROPERTY:**  
 2763 RILEY ROAD  
 Eagle Point OR 97524  
 CITY/STATE/ZIP:  
 42.4665 / -122.7821

**CUSTOMER:** Department of Veterans Affairs  
**CONTACT:** Online Report  
**INQUIRY #:** October 07, 2010 8:50 am  
**DATE:**

## MAP FINDINGS

Map ID Direction Distance Elevation	Site	EDR ID Database
1 South 1/2-1 mi 4665 Lower	SRDCOR200701252 RF517257 Family Child Care Home Page, Kathryn Lorraine 598 Vista Park Dr Not Reported Eagle Point OR 97524 Not Reported 598 Vista Park Dr Eagle Point OR 97524 5418265991 Not Reported 11/30/2006 11/30/2008 Active English Jackson 9 Not Reported 10 Not Reported Min. age in months: Max age in months: Hours of operation: Days: For profit: Ratio:	SRDCOR200701252 Daycare
2 NE 1/2-1 mi 5164 Lower	SRHO20070350106 AHA Hospitals	SRHO20070350106 AHA Hospitals

## MAP FINDINGS

Map ID Direction Distance Elevation	Site	EDR ID Database
38 LAB 940 AURES RD 5419474900 08 20040118 Not Reported 10 97524 41 029 354 E Not Reported Not Reported 0000 0000 US_HOSPITAL_POSCLIA SRHO20070350106	sea state: state region cd: street address: Phone num: Termination reason: Term Date: Purpose of action: Provider control: Zip: Fips state: Fips cnty: SSA MSA: SSA MSA size code: Date accredited: Accred Org: Num beds: Num cert beds: Source: Edr id:	SRDCOR200701278 RF518309 Family Child Care Home Sayre, Monika J 633 E Archwood Unit 57 Not Reported Eagle Point OR 97524 Not Reported 4/5/2006 4/5/2008 Active English Jackson 9 Not Reported 10 Not Reported Max age in months: Hours of operation: Days: For profit: Ratio:
A3 NW 1/2-1 mi 5250 Lower	SRDCOR200701278 RF518309 Family Child Care Home Sayre, Monika J 633 E Archwood Unit 57 Not Reported Eagle Point OR 97524 Not Reported 4/5/2006 4/5/2008 Active English Jackson 9 Not Reported 10 Not Reported Max age in months: Hours of operation: Days: For profit: Ratio:	SRDCOR200701278 Daycare

## MAP FINDINGS

Map ID	Direction	Distance	Elevation	Site	EDR ID	Database
A4	NW	1/2-1 mi	5250	Lower	SRDCOR200701615	Daycare

**EDR ID:** SRDCOR200701615  
**License number:** RF517256  
**Facility type:** Family Child Care Home  
**Facility name:** Thompson, Jenny Melissa  
**Facility address:** 633 E Archwood Unit 65  
**Facility city:** Not Reported  
**Facility state:** Eagle Point  
**Facility zip:** OR  
**Zip 4:** 97524  
**Mailing address:** Not Reported  
**Mailing city:** 633 E Archwood Unit 65  
**Mailing state:** Eagle Point  
**Mailing zip:** OR  
**Phone:** 97524  
**5413249588**  
**Certifier:** Not Reported  
**Start date:** 5/4/2006  
**Expire date:** 5/4/2008  
**Status:** Active  
**Language:** English  
**County:** Jackson  
**SDA:** 9  
**Director:** Not Reported  
**Capacity:** 10  
**Min. age in months:** Not Reported  
**Max age in months:** Not Reported  
**Hours of operation:** Not Reported  
**Days:** Not Reported  
**For profit:** Not Reported  
**Ratio:** Not Reported

## RECORDS SEARCHED/DATA CURRENCY TRACKING

### Census

Source: U.S. Census Bureau  
 Telephone: 301-457-4100  
 2000 U.S. Census data was used to estimate residential population following these EPA guidelines: "Census data are presented by Census tract. If your circle covers only a portion of the tract, you should develop an estimate for that portion...Determine the population density per square mile (total population of the Census tract divided by the number of square miles in the tract) and apply that density figure to the number of square miles within your circle."

### FED LAND: Federal Lands

Source: USGS  
 Telephone: 888-275-8747  
 Federal lands data. Includes data from several Federal land management agencies, including Fish and Wildlife Service, Bureau of Land Management, National Park Service, and Forest Service. Includes National Parks, Forests, Monuments, Wildlife Sanctuaries, Preserves, Reluges, Federal Wilderness Areas.

### AHA Hospitals:

Source: American Hospital Association, Inc.  
 Telephone: 312-280-5991  
 The database includes a listing of hospitals based on the American Hospital Association's annual survey of hospitals.

### Medical Centers: Provider of Services Listing

Source: Centers for Medicare & Medicaid Services  
 Telephone: 410-786-3000  
 A listing of hospitals with Medicare provider number, produced by Centers of Medicare & Medicaid Services, a federal agency within the U.S. Department of Health and Human Services.

### Nursing Homes

Source: National Institutes of Health  
 Telephone: 301-594-6248  
 Information on Medicare and Medicaid certified nursing homes in the United States.

### Public Schools

Source: National Center for Education Statistics  
 Telephone: 202-502-7300  
 The National Center for Education Statistics' primary database on elementary and secondary public education in the United States. It is a comprehensive, annual, national statistical database of all public elementary and secondary schools and school districts, which contains data that are comparable across all states.

### Private Schools

Source: National Center for Education Statistics  
 Telephone: 202-502-7300  
 The National Center for Education Statistics' primary database on private school locations in the United States.

### Colleges - Integrated Postsecondary Education Data

Source: National Center for Education Statistics  
 Telephone: 202-502-7300  
 The National Center for Education Statistics' primary database on integrated postsecondary education in the United States.

### Arenas

Source: Dunhill International  
 EDR indicates the location of buildings and facilities - arenas - where individuals who are public receptors are likely to be located.

### Prisons: Bureau of Prisons Facilities

Source: Federal Bureau of Prisons  
 Telephone: 202-307-3198  
 List of facilities operated by the Federal Bureau of Prisons.

### Daycare Centers: Child Care Listings

Source: Employment Department  
 Telephone: 503-947-1420

### STREET AND ADDRESS INFORMATION

(C) 2010 Tele Atlas North America, Inc. All rights reserved. This material is proprietary and the subject of copyright protection and other intellectual property rights owned by or licensed to Tele Atlas North America, Inc. The use of this material is subject to the terms of a license agreement. You will be held liable for any unauthorized copying or disclosure of this material.