

United States Department of the Interior  
National Park Service

National Register of Historic Places  
Registration Form

This form is for use in nominating or requesting determinations for individual properties and districts. **How to Complete the National Register of Historic Places Registration Form (National Register Bulletin 16A):** Complete each item by marking "X" in the appropriate box or by entering the information requested. If any item does not apply to the property being documented, enter "N/A" for "not applicable." For functions, architectural classification, materials, and areas of significance, enter only categories and subcategories from the instructions. Place additional entries and narrative items on continuation sheets (NPS Form 10-900a). Use a typewriter, word processor, or computer, to complete all items.

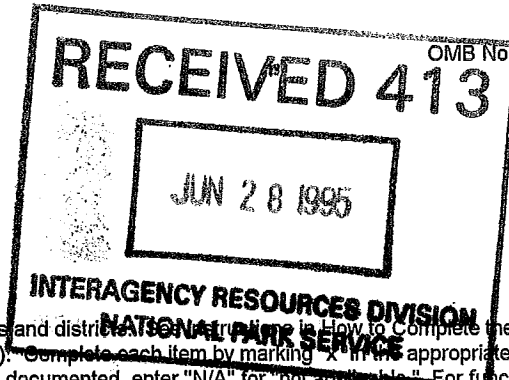

1. Name of Property

historic name City Point National Cemetery

other names/site number Virginia Department of Historic Resources File No. 116-8

2. Location

street & number 10th Avenue and Davis Street  not for publication N/A

city or town Hopewell  vicinity N/A

state Virginia code VA county Hopewell (Ind. City) code 670 zip code 23860

3. State/Federal Agency Certification

As the designated authority under the National Historic Preservation Act of 1986, as amended, I hereby certify that this  nomination  request for determination of eligibility meets the documentation standards for registering properties in the National Register of Historic Places and meets the procedural and professional requirements set forth in 36 CFR Part 60. In my opinion, the property  meets  does not meet the National Register Criteria. I recommend that this property be considered significant  nationally  statewide  locally. (  See continuation sheet for additional comments.)

Karen Rome Dupak 3/14/95  
Signature of certifying official/Title Federal Preservation Officer Date  
Department of Veterans Affairs  
State or Federal agency and bureau

In my opinion, the property  meets  does not meet the National Register criteria. (  See continuation sheet for additional comments.)

Julia M. Bosnik 6/15/95  
Signature of commenting or other official/Title \_\_\_\_\_ Date  
Virginia Department of Historic Resources  
State or Federal agency and bureau

4. National Park Service Certification

- I hereby certify that this property is:
- entered in the National Register
    - See continuation sheet.
  - determined eligible for the National Register
    - See continuation sheet.
  - determined not eligible for the National Register
  - removed from the National Register
  - other, (explain:)

Signature of Keeper Patrick Andrews Date of Action 8/10/95

City Point National Cemetery  
Name of Property

City of Hopewell, Virginia  
County and State

**5. Classification**

**Ownership of Property**  
(Check as many boxes as apply)

- private
- public-local
- public-State
- public-Federal

**Category of Property**  
(Check only one box)

- building(s)
- district
- site
- structure
- object

**Number of Resources within Property**  
(Do not include previously listed resources in the count.)

Contributing	Noncontributing	
3	0	buildings
1	0	sites
2	0	structures
2	0	objects
8	0	Total

**Name of related multiple property listing**  
(Enter "N/A" if property is not part of a multiple property listing.)

Civil War Era National Cemeteries

**Number of contributing resources previously listed in the National Register**

0

**6. Function or Use**

**Historic Functions**  
(Enter categories from instructions)

Funerary: Cemetery  
\_\_\_\_\_  
\_\_\_\_\_  
\_\_\_\_\_  
\_\_\_\_\_  
\_\_\_\_\_  
\_\_\_\_\_  
\_\_\_\_\_

**Current Functions**  
(Enter categories from instructions)

Funerary: Cemetery  
\_\_\_\_\_  
\_\_\_\_\_  
\_\_\_\_\_  
\_\_\_\_\_  
\_\_\_\_\_  
\_\_\_\_\_

**7. Description**

**Architectural Classification**  
(Enter categories from instructions)

Late 19th and 20th Century Revivals: Colonial Revival  
\_\_\_\_\_  
\_\_\_\_\_  
\_\_\_\_\_

**Materials**  
(Enter categories from instructions)

foundation Stone, concrete  
walls Brick, stucco, wood  
roof Synthetics: Fiberglass; Metal: Tin  
other Stone: Marble; Metal: Iron  
Other: Uncoursed fieldstone

**Narrative Description**

(Describe the historic and current condition of the property on one or more continuation sheets.)

City Point National Cemetery  
Name of Property

City of Hopewell, Virginia  
County and State

**8. Statement of Significance**

**Applicable National Register Criteria**

(Mark "x" in one or more boxes for the criteria qualifying the property for National Register listing.)

- A** Property is associated with events that have made a significant contribution to the broad patterns of our history.
- B** Property is associated with the lives of persons significant in our past.
- C** Property embodies the distinctive characteristics of a type, period, or method of construction or represents the work of a master, or possesses high artistic values, or represents a significant and distinguishable entity whose components lack individual distinction.
- D** Property has yielded, or is likely to yield, information important in prehistory or history.

**Criteria Considerations**

(Mark "x" in all boxes that apply.)

Property is:

- A** owned by a religious institution or used for religious purposes.
- B** removed from its original location.
- C** a birthplace or grave.
- D** a cemetery.
- E** a reconstructed building, object or structure.
- F** a commemorative property.
- G** less than 50 years of age or achieved significance within the past 50 years.

**Narrative Statement of Significance**

(Explain the significance of the property on one or more continuation sheets.)

**9. Major Bibliographical References**

**Bibliography**

(Cite the books, articles, and other sources used in preparing this form on one or more continuation sheets.)

**Previous documentation on file (NPS):**

- preliminary determination of individual listing (36 CFR 67) has been requested
- previously listed in the National Register
- previously determined eligible by the National Register
- designated a National Historic Landmark
- recorded by Historic American Buildings Survey # \_\_\_\_\_
- recorded by Historic American Engineering Record

**Areas of Significance**

(Enter categories from instructions)

Military

**Period of Significance**

1866-1936

**Significant Dates**

1866

**Significant Person**

(Complete if Criterion B is marked above)

N/A

**Cultural Affiliation**

N/A

**Architect/Builder**

N/A

**Primary location of additional data:**

- State Historic Preservation Office
- Other State agency
- Federal agency
- Local government
- University
- Other

Name of repository

Department of Veterans Affairs

City Point National Cemetery  
Name of Property

City of Hopewell, Virginia  
County and State

**10. Geographical Data**

Acreage of Property 6.6

**UTM References**

(Place additional UTM references on a continuation sheet)

1	<u>18</u> Zone	<u>296360</u> Easting	<u>4131020</u> Northing
2			

3			
4			

See continuation sheet.

**Verbal Boundary Description**

(Describe the boundaries of the property on a continuation sheet.)

**Boundary Justification**

(Explain why the boundaries were selected on a continuation sheet.)

**11. Form Prepared By**

name/title Therese T. Sammartino, Staff Assistant, National Cemetery System  
organization Department of Veterans Affairs date March 8, 1995  
street & number 810 Vermont Avenue, N.W. telephone (202) 523-3895  
city or town Washington, D.C. state \_\_\_\_\_ zip code 20420

**Additional Documentation**

Submit the following items with the completed form:

**Continuation Sheets**

**Maps**

A USGS map (7.5 or 15 minute series) indicating the property's location.

A sketch map for historic districts and properties having large acreage or numerous resources.

**Photographs**

Representative **black and white** photographs of the property.

**Additional items**

(Check with the SHPO or FPO for any additional items)

**Property Owner**

(Complete this item at the request of the SHPO or FPO.)

name Department of Veterans Affairs telephone \_\_\_\_\_  
street & number 810 Vermont Avenue, N.W.  
city or town Washington, D.C. state \_\_\_\_\_ zip code 20420

**Paperwork Reduction Act Statement:** This information is being collected for applications to the National Register of Historic Places to nominate properties for listing or determine eligibility for listing, to list properties, and to amend existing listings. Response to this request is required to obtain a benefit in accordance with the National Historic Preservation Act, as amended (16 U.S.C. 470 et seq.).

**Estimated Burden Statement:** Public reporting burden for this form is estimated to average 18.1 hours per response including the time for reviewing instructions, gathering and maintaining data, and completing and reviewing the form. Direct comments regarding this burden estimate or any aspect of this form to the Chief, Administrative Services Division, National Park Service, P.O. Box 37127, Washington, DC 20013-7127; and the Office of Management and Budget, Paperwork Reductions Project (1024-0018), Washington, DC 20503.

United States Department of the Interior  
National Park Service

National Register of Historic Places  
Continuation Sheet

Section number 7 Page 1

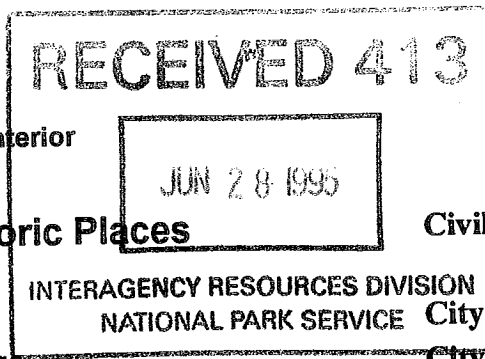

Civil War Era National Cemeteries  
City Point National Cemetery  
City of Hopewell, Virginia

## NARRATIVE DESCRIPTION

The City Point National Cemetery is located at 10th Avenue and Davis Street in Hopewell, Virginia, on the south bank of the Appomattox River. The cemetery is in the form of a rectangle with a semicircular entrance projection in the center of the east side. The entire cemetery is enclosed by an uncoursed fieldstone wall, approximately 4 feet in height. The main entrance is protected by a double wrought-iron gate, supported by stone piers. The main entry gate was constructed in 1941, typical of that period when new entries at many of the national cemeteries replaced original gates that were too narrow to accommodate modern automobiles. This gate is marked by two limestone columns, approximately 8 feet high. They are designed in a modern classical form with eagles incised on the front face and topped by 12-inch-wide limestone balls. The original wrought-iron entry gate (3 feet wide) is now an auxiliary/pedestrian gate to the lodge. There is a third wrought-iron gate (13 feet wide), which opens to the service building. The flagpole is located in the northwest quadrant of the cemetery. On a north-south axis with the flagpole is a grassed circle, 50 feet in diameter, where a white marble monument is located. The monument is approximately 20 feet high, and was dedicated to the memory of the dead of the Army of the James by direction of Major General B. F. Butler, Commander of the Army of the James from April 1864 to January 1865. The inscription, on three sides, reads as follows:

Sacred to the lamented dead of the Army of the James  
Surgeon in charge of Point of Rocks Hospital  
Erected by Major General G.B.F. Butler  
George Suckley  
Surg U S Volunteers  
Colonel and Medical Director  
H.B. Fowler  
Surg 12 NH Vol

Records available regarding this monument focus on size, by whom dedicated, and the inscription. No information is inscribed on the monument as to the name of the sculptor or the foundry which fabricated the memorial.

The cemetery was established in July 1866 and contains six burial sections. The graves were originally marked by headboards, painted white and properly lettered. The boards were later replaced by upright marble headstones. As of January 31, 1995, there were 5,497 graves used for the interment of 6,742 casketed remains and 42 sites used for the interment of 55 cremated remains. There are 1,423 unknown Civil War soldiers interred in the cemetery. There are 5,156 interments of soldiers and sailors of the Civil War, of which 118 are Confederates and the remainder Union.

The cemetery officially closed for interments on July 26, 1971. Burials in occupied and reserved graves continue. As of January 31, 1995, there were 59 sites available (all reserved) for the interment of casketed remains, but there were no sites available for the interment of cremated remains.

United States Department of the Interior  
National Park Service

**National Register of Historic Places  
Continuation Sheet**

**Civil War Era National Cemeteries**

**City Point National Cemetery  
City of Hopewell, Virginia**

Section number 7 & 8 Page 2

---

**NARRATIVE DESCRIPTION (Continued)**

In 1868, the original lodge was constructed as a residence and office for the superintendent. In 1928, it was demolished and a new lodge was constructed. It is a one-and-one-half-story, six-room, brick and stucco building with a gambrel roof. The roof was originally clad with wooden shingles, now replaced by fiberglass. The lodge is located within the area of the semicircular projection on the east side of the cemetery.

A brick outbuilding containing a stable, tool house, and wood house, as well as a frame shed in the rear, were demolished in 1928, and a new combination brick and concrete service building was constructed. Its gambrel roof was originally clad with wooden shingles that have been replaced by fiberglass. A brick gasoline storage shed, 6 feet 4 inches by 5 feet 4 inches, was constructed in June 1936.

The numbers shown for contributing resources within the property reflect the following:

**Buildings:** Lodge, service building, gasoline storage shed

**Sites:** Cemetery

**Structures:** Gate, perimeter wall

**Objects:** Flagpole, Army of the James monument

**NARRATIVE STATEMENT OF SIGNIFICANCE**

The City Point National Cemetery is significant under Criterion A and is an important component of the multiple property submission of Civil War Era National Cemeteries. It is significant because of its association with the Civil War.

At City Point, on the James and Appomattox Rivers, the Union Army established a great supply depot for the receipt of troops and vast quantities of all manner of materiel of war in preparation for another try for Richmond. From June 1864 until April 1865, City Point was the "busiest place in Dixie." While General Robert E. Lee's outnumbered Confederates fought and starved behind their slowly crumbling defenses at Petersburg, here, just eight miles away, General Ulysses S. Grant built up one of the largest supply depots of the Civil War which, during the ten months of its existence, kept his army the best-fed, best-clothed, and best-munitioned in the field.

United States Department of the Interior  
National Park Service

**National Register of Historic Places  
Continuation Sheet**

Civil War Era National Cemeteries

City Point National Cemetery

City of Hopewell, Virginia

Section number 8 Page 3

---

**NARRATIVE STATEMENT OF SIGNIFICANCE (Continued)**

Grant's objective was to capture Petersburg, a vital communication center and then to advance upon Richmond from south of the James River. From June 1864 to April 1865, heavy siege action by the forces of the Union and desperate and stubborn defense tactics by Lee's Army of Northern Virginia characterized the campaign that brought Grant's forces to Petersburg and ultimately into the streets of Richmond.

A large Army general hospital at City Point cared for some of the sick and the wounded. A burial ground was established near the Union hospital at City Point, and many of the combatants of the 1864-1865 siege of Petersburg and Richmond are interred near the hospital. Following the cessation of hostilities, this burial ground became a part of the national cemetery. Following the close of the Civil War, the cemetery expanded, as other remains not originally buried in the national cemetery were recovered from other burial grounds at City Point, from Point of Rocks in Chesterfield County, and a few from Harrison's Landing in Charles City County.

The cemetery was established in July 1866 and consists of 6.6 acres. The land that comprised the national cemetery was from a tract known as "Cawsons," owned by Mr. Edward Comer, a local farmer. Land was acquired by Decree of Condemnation rendered on January 16, 1868, and consisted of 6.45 acres in cemetery area and approximately 0.89 acre of roadway. The deed from Mr. Comer conveying the land was dated January 23, 1868. A deed from Charles Comer, dated December 21, 1872, conveyed a strip of land to build a wall around the cemetery. By deed dated October 26, 1939, the City of Hopewell conveyed two parcels totaling .126 acres. By Quitclaim Deed dated June 14, 1941, the cemetery approach road (0.89 acre) was conveyed to the City of Hopewell.

In 1955, the remains of 17 unknown soldiers of the Civil War were discovered during an excavation of some vacant lots in Hopewell, Virginia (apparently the site of an abandoned cemetery). Buttons from both Union and Confederate uniforms were found in some of the graves uncovered at that time. Reinterment of these remains was made in the City Point National Cemetery. Again, in 1959, two remains determined to be those of unknown Union soldiers, were recovered from shallow graves in the path of Interstate Route 95. These remains were reinterred in the national cemetery on August 12, 1959. In 1982, the skeletal remains of yet another Union soldier were discovered near Hopewell, Virginia. Reinterment was made on Memorial Day 1982.

United States Department of the Interior  
National Park Service

**National Register of Historic Places  
Continuation Sheet**

Civil War Era National Cemeteries

City Point National Cemetery  
City of Hopewell, Virginia

Section number 9 & 10 Page 4

---

**MAJOR BIBLIOGRAPHICAL REFERENCES**

National Cemetery System Microfilm Records

Department of Veterans Affairs Historic Preservation Office

Bradford, Ned. Battles and Leaders of the Civil War. New York: The Fairfax Press, 1979.

Battlefields of the Civil War. New York: Arno, 1979.

**GEOGRAPHICAL DATA - VERBAL BOUNDARY DESCRIPTION**

**PARCEL 1 -6.45 ACRES**

Beginning at a point on the South Bank of the Appomattox River and running due W. a distance of 420 feet; thence due N., a distance of 620 feet; thence due E. a distance of 420 feet; thence due S a distance of 189 1/2 feet; thence with a radius of 10 feet, curve to the left a distance of 15 7/10 feet, thence with a radius of 110 1/2 feet curve to the right a distance of 347 1/10 feet curve to the left a distance of 15 7/10 feet, thence due S. a distance of 189 1/2 feet to the point of beginning and enclosing the cemetery: 6 45/100 acres.

**PARCEL 2 - .084 ACRE**

Beginning at a point in the west line of North 10th Avenue, said point being South 4 degrees 29 minutes East, twelve and five-tenths (12.5) feet from a concrete monument in the northwest corner of the intersection of Davis Street and North 10th Avenue; thence South 4 degrees 29 minutes East, along the west line of North 10th Avenue, a distance of twenty (20) feet to a point; thence North 85 degrees 31 minutes East, paralleling the south line of Davis Street and distant twelve and five-tenths (12.5) feet from said line, a distance of one hundred eighty-four and eight/one-hundredths (184.08) feet to a point in the west line of the United States Government-owned twenty foot strip known as Memorial Avenue; thence North 12 degrees 16 minutes West, along the west line of said Memorial Avenue, a distance of twenty and eighteen one hundredths (20.18) feet to a point; thence South 85 degrees 31 minutes West, paralleling the north line of Davis Street and distant twelve and five-tenths (12.5) feet from said line, a distance of one hundred eighty-one and thirty-five one-hundredths (181.35) feet to the point of beginning and containing 0.084 acres, more or less.



United States Department of the Interior  
National Park Service

**National Register of Historic Places  
Continuation Sheet**

Civil War Era National Cemeteries

City Point National Cemetery  
City of Hopewell, Virginia

Section number 10 Page 5

---

**GEOGRAPHICAL DATA - VERBAL BOUNDARY DESCRIPTION (Continued)**

**PARCEL 3 - .042 ACRE**

Beginning at a point on a concrete monument in the northwest corner of the intersection of North 10th Avenue and Davis Street; thence South 4 degrees 29 minutes East along the west line of North 10th Avenue, a distance of thirty-two and five/tenths (32.5) feet to a point; thence South 85 degrees 31 minutes West, a distance of one hundred one and seven/tenths (101.7) feet to an iron pipe on the property line of the United States National Cemetery; thence North 0 degrees 20 minutes East, along said property line a distance of three and sixteen/one hundredths (3.16) feet to a point; thence continuing along said property line by a curve to the right having a radius of nine and seventy-five/one hundredths (9.75) feet an arc length of fifteen and thirty-two/one hundredths (15.32) feet, which is by chord North 45 degrees 20 minutes East, thirteen and seventy-nine/one hundredths (13.79) feet, to a point; thence continuing along said property line by a curve to the left having a radius of one hundred thirteen and six/tenths (113.6) feet an arc length of one hundred and twenty-four/one-hundredths (100.24) feet, which is by chord North 65 degrees 03 minutes 15 seconds East, ninety-seven and two/one-hundredths (97.02) feet to a point; thence South 4 degrees 29 minutes East a distance of thirteen and forty six/one hundredths (13.46) feet to the point of beginning and containing 0.042 acres, more or less.

**BOUNDARY JUSTIFICATION**

The National Cemetery System has used the existing boundaries of the cemetery.

United States Department of the Interior  
National Park Service

National Register of Historic Places  
Continuation Sheet

Civil War Era National Cemeteries

City Point National Cemetery  
City of Hopewell, Virginia

Section number          PHOTO Page          6

All photographs are of:

CITY POINT NATIONAL CEMETERY  
City of Hopewell, Virginia  
VDHR File No. 116-8  
Mr. James Brownie, photographer  
Date of Photographs: September 27, 1994

All negatives are stored with Technical Support Service (401B), National Cemetery System, Department of Veterans Affairs, 810 Vermont Avenue, N.W., Washington, D.C. 20420

VIEW OF: Main entry gate (constructed in 1941), view looking south  
NEG. NO. 5988-2  
PHOTO 1 of 10

VIEW OF: Service building and gasoline storage shed, view looking southeast  
NEG. NO. 5988-9  
PHOTO 6 of 10

VIEW OF: Auxiliary/pedestrian entry to lodge (original entry gate), view looking west  
NEG. NO. 5988-3  
PHOTO 2 of 10

VIEW OF: Service building, west elevation  
NEG. NO. 5988-8  
PHOTO 7 of 10

VIEW OF: Flagpole, view looking southwest  
NEG. NO. 5988-10  
PHOTO 3 of 10

VIEW OF: Lodge, west elevation  
NEG. NO. 5988-13  
PHOTO 8 of 10

VIEW OF: Lodge, east elevation  
NEG. NO. 5988-7  
PHOTO 4 of 10

VIEW OF: Army of the James monument, view looking west  
NEG. NO. 5988-11  
PHOTO 9 of 10

VIEW OF: Lodge, south elevation  
NEG. NO. 5988-5  
PHOTO 5 of 10

VIEW OF: Army of the James monument, view looking east  
NEG. NO. 5988-12  
PHOTO 10 of 10

Sketch Map  
City Point National Cemetery  
City of Hopewell, Virginia

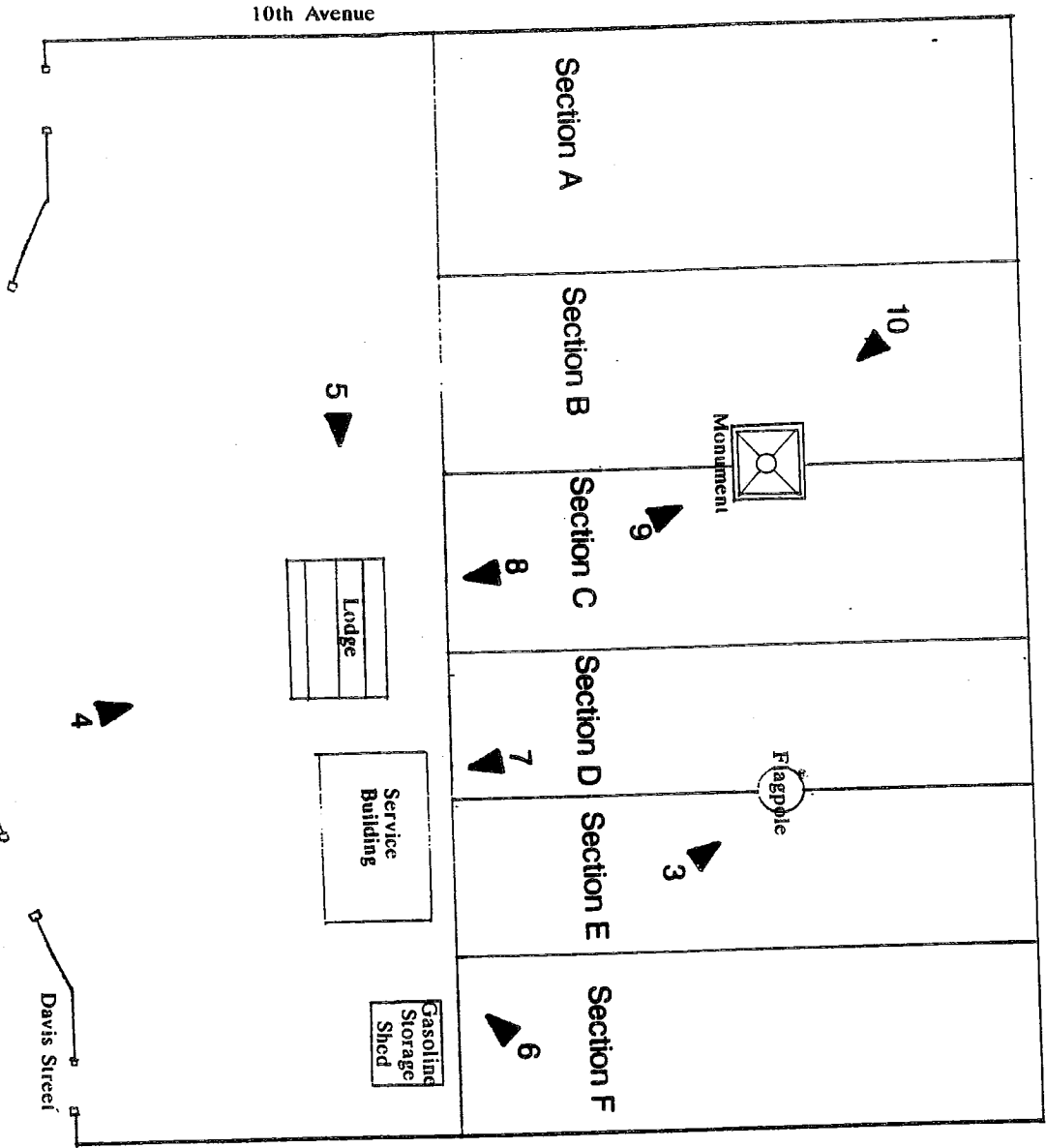

North  
NOT TO SCALE

Note: Numbered triangles correspond to the views in the accompanying photographs

# E.O. 11593

**DETERMINATION OF ELIGIBILITY NOTIFICATION**  
**National Register of Historic Places**  
**Heritage Conservation and Recreation Service**

---

**Name of property:** City Point National Cemetery

**Location:** Hopewell

**State:** VA

**Request submitted by:** VA/Gjore Mollenhoff

**Date received:** 2-15-80

**Additional information received:** 2-20-80

---

**Opinion of the State Historic Preservation Officer:**

Eligible

Not Eligible

No Response

**Comments:**

**The Secretary of the Interior has determined that this property is:**

Eligible      Applicable criteria: A

Not Eligible

**Comments:**

36 CFR Part 63.3  
Determination

Documentation insufficient

(Please see accompanying sheet explaining additional materials required)

Bill W. W. W.  
Keeper of the National Register

Date: March 6, 1980